

Submittal Sheets

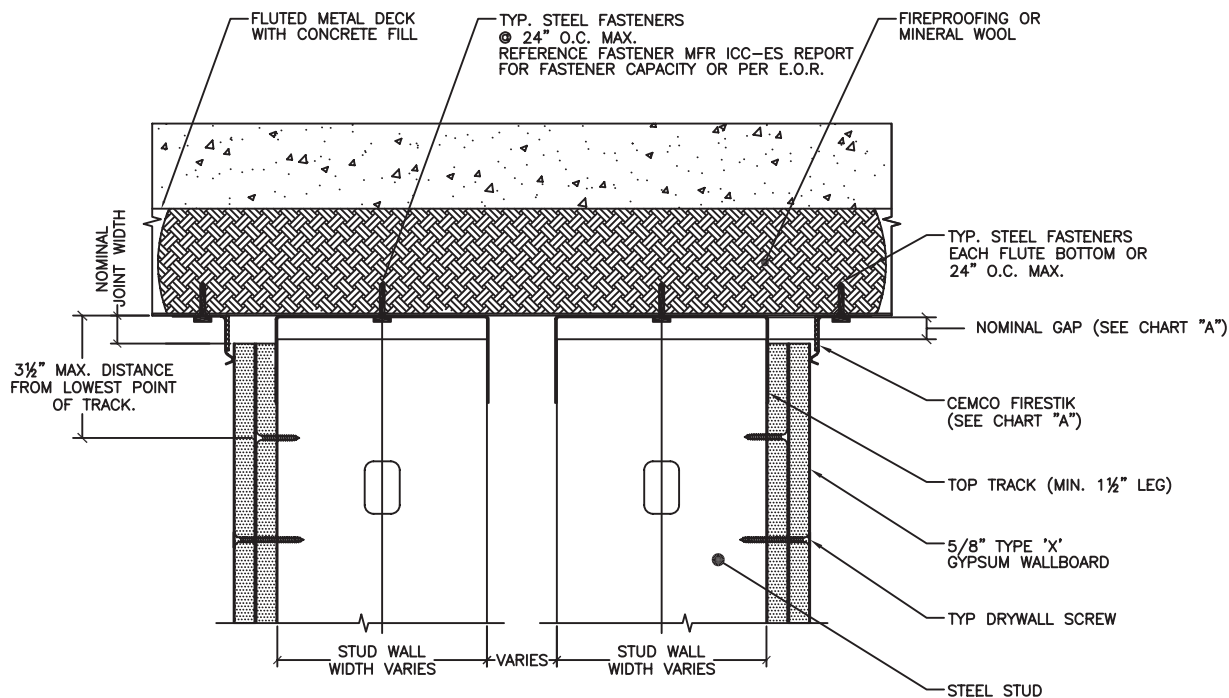

CHART "A"

FIRESTICK PROFILE	NOMINAL GAP	+/- VERT. MOVEMENT	TOTAL DEFLECTION
FS1	1/2"	1/2"	1"
FS2	1"	1"	2"

NOTES:

1. Cyclical Design - UL 2079 Test Standard.
2. Do not screw drywall or stud to track.
3. Track Leg min. 1/2" longer than total deflection.
4. Consult manufacturer on track movement capabilities.
5. Reference ITS / Warnock Hersey directory for specific information.
6. Reference UL Fire Resistance Directory for specific information.

HEAD OF WALL SYSTEM 1, PERPENDICULAR TO FLUTE DETAIL,
1 AND 2 HOUR FIRE RESISTANT ASSEMBLY.
(SEE UL LISTING FOR WALL FIRE RATING).



UL-2079 TEST STD.